

| No | GBR/CAA Intermediate Schedule            | K |
|----|--|---|
| 1  | Take-off Sequence                        | 2 |
| 2  | 45 Degree Up with ½ Roll, Exit Inverted  | 2 |
| 3  | Half Loop                                | 1 |
| 4  | Slow Roll                                | 2 |
| 5  | Stall Turn                               | 2 |
| 6  | Square Loop with ½ Rolls in legs 1 and 3 | 3 |
| 7  | Immelman Turn with Half Roll             | 2 |
| 8  | Two Outside Loops                        | 2 |
| 9  | Split S                                  | 2 |
| 10 | Cuban Eight with Half Rolls              | 3 |
| 11 | Humpty Bump with Options                 | 2 |
| 12 | Four Point Roll                          | 4 |
| 13 | Half Square Loop, Half Roll Up           | 2 |
| 14 | Three Turn Spin                          | 4 |
| 15 | Landing Sequence                         | 2 |

Max. Score = 350

Promotion = 210 (60%)

| No | GBR/CAA Intermediate Schedule            | K |
|----|--|---|
| 1  | Take-off Sequence                        | 2 |
| 2  | 45 Degree Up with ½ Roll, Exit Inverted  | 2 |
| 3  | Half Loop                                | 1 |
| 4  | Slow Roll                                | 2 |
| 5  | Stall Turn                               | 2 |
| 6  | Square Loop with ½ Rolls in legs 1 and 3 | 3 |
| 7  | Immelman Turn with Half Roll             | 2 |
| 8  | Two Outside Loops                        | 2 |
| 9  | Split S                                  | 2 |
| 10 | Cuban Eight with Half Rolls              | 3 |
| 11 | Humpty Bump with Options                 | 2 |
| 12 | Four Point Roll                          | 4 |
| 13 | Half Square Loop, Half Roll Up           | 2 |
| 14 | Three Turn Spin                          | 4 |
| 15 | Landing Sequence                         | 2 |

Max. Score = 350

Promotion = 210 (60%)

| No | GBR/CAA Intermediate Schedule            | K |
|----|--|---|
| 1  | Take-off Sequence                        | 2 |
| 2  | 45 Degree Up with ½ Roll, Exit Inverted  | 2 |
| 3  | Half Loop                                | 1 |
| 4  | Slow Roll                                | 2 |
| 5  | Stall Turn                               | 2 |
| 6  | Square Loop with ½ Rolls in legs 1 and 3 | 3 |
| 7  | Immelman Turn with Half Roll             | 2 |
| 8  | Two Outside Loops                        | 2 |
| 9  | Split S                                  | 2 |
| 10 | Cuban Eight with Half Rolls              | 3 |
| 11 | Humpty Bump with Options                 | 2 |
| 12 | Four Point Roll                          | 4 |
| 13 | Half Square Loop, Half Roll Up           | 2 |
| 14 | Three Turn Spin                          | 4 |
| 15 | Landing Sequence                         | 2 |

Max. Score = 350

Promotion = 210 (60%)

| No | GBR/CAA Intermediate Schedule            | K |
|----|--|---|
| 1  | Take-off Sequence                        | 2 |
| 2  | 45 Degree Up with ½ Roll, Exit Inverted  | 2 |
| 3  | Half Loop                                | 1 |
| 4  | Slow Roll                                | 2 |
| 5  | Stall Turn                               | 2 |
| 6  | Square Loop with ½ Rolls in legs 1 and 3 | 3 |
| 7  | Immelman Turn with Half Roll             | 2 |
| 8  | Two Outside Loops                        | 2 |
| 9  | Split S                                  | 2 |
| 10 | Cuban Eight with Half Rolls              | 3 |
| 11 | Humpty Bump with Options                 | 2 |
| 12 | Four Point Roll                          | 4 |
| 13 | Half Square Loop, Half Roll Up           | 2 |
| 14 | Three Turn Spin                          | 4 |
| 15 | Landing Sequence                         | 2 |

Max. Score = 350

Promotion = 210 (60%)

### GBR/CAA Intermediate Schedule

ACS. Dec 2005

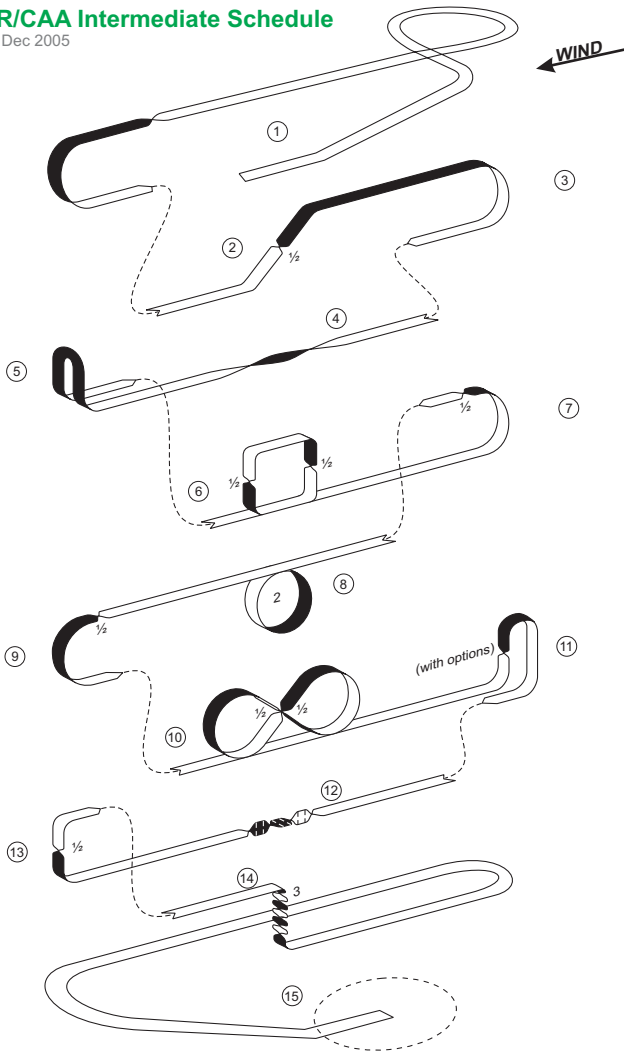

### GBR/CAA Intermediate Schedule

ACS. Dec 2005

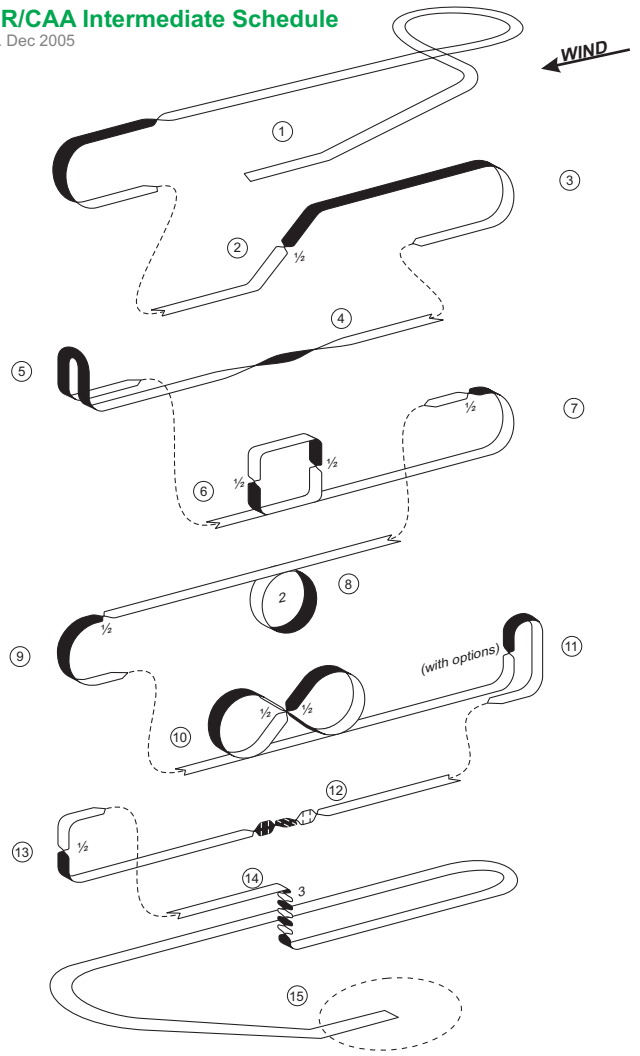

### GBR/CAA Intermediate Schedule

ACS. Dec 2005

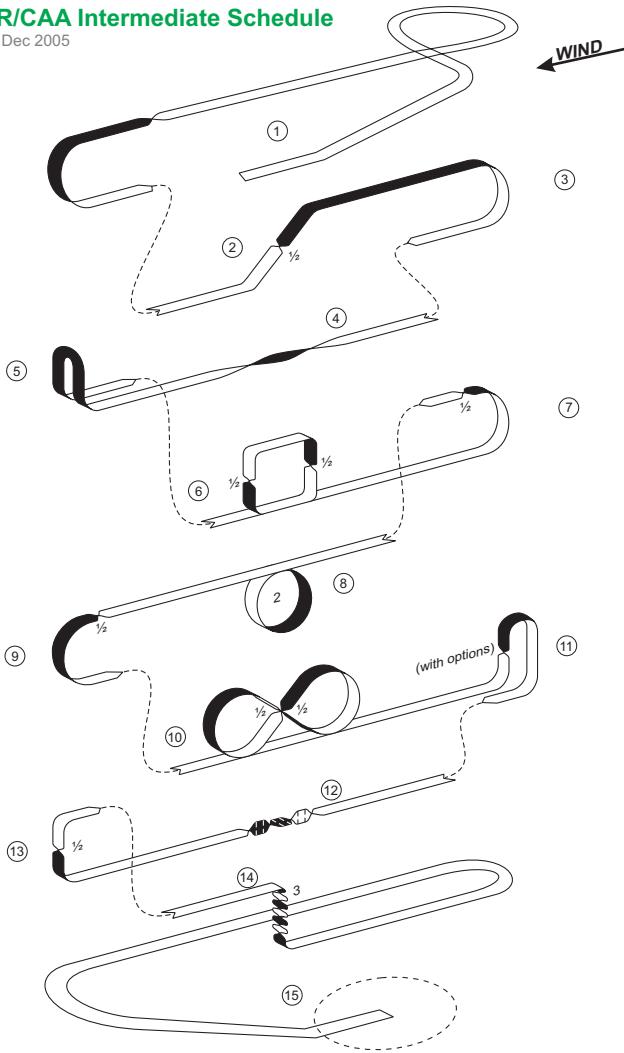

### GBR/CAA Intermediate Schedule

ACS. Dec 2005

